

Door
Soundabsorbing Folding Door

asset
space becomes place

**Doooor
is like a
blank
canvas in
an artist's
hands:
pure
potential**

Opening system

Door folding doors feature opening systems designed to enhance spaces of various kinds. Small and narrow spaces are best suited to lateral opening doors.

Bilateral opening allows you to make use of the whole space, with its characteristic double passage. When used for wardrobes, it enables 100% of their storage capacity to be utilised.

Centred central opening is appropriate for large rooms, creating a central passageway which varies according to requirements. Two side elements complete the picture, framing the whole.

A decentred central opening responds to specific requirements of the space where it is installed.

Multiple opening permits maximum versatility and practicality, designed to complement all the systems described above. In large spaces it plays two roles, giving each element the right balance and amplifying its usability.

Lateral opening



Bilateral opening



Centred central opening

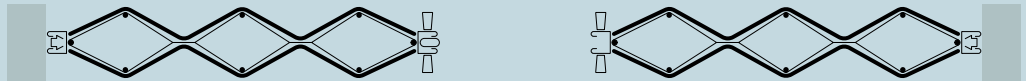

Decentred central opening

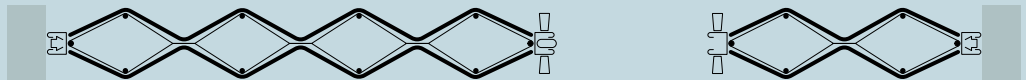

Multiple opening



Track

The aluminium track is the product of a technology in which steel pivots connect multiple modules, permitting potentially infinite length. The accuracy of this alignment adds fluidity to its movement.

This element may be visible (when the door is folded), or built-in to blend into the ceiling for improved appearance.

Tracks may be curved (with a minimum curve radius of 600 mm) to give the door a sinuous silhouette.

Door folding doors have two kinds of tracks: standard and adjustable.

The standard track is small (29 mm) with rounded corners for a softer shape. The adjustable track is adaptable in height (0-27 mm) to meet out-of-square needs.

Standard track

29x29 mm

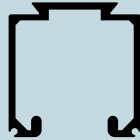

Adjustable track

33x46 mm

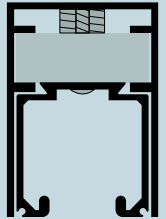

Height compensation with adjustable track

33x57 mm
33x61 mm
33x70 mm

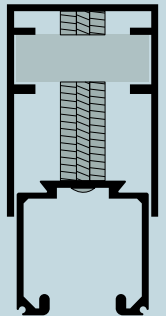
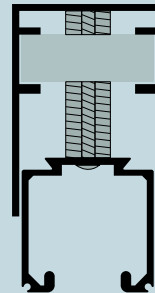
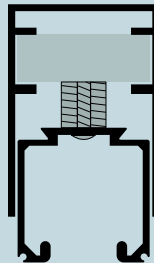

Visible standard track

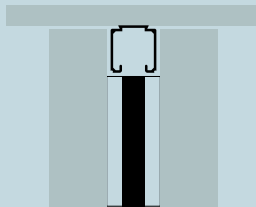

Built-in standard track

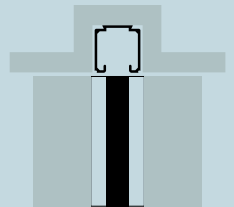

Visible adjustable track

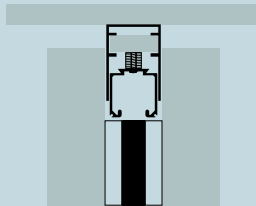

Built-in adjustable track

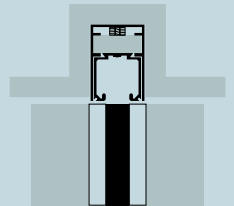

Closing system

The closing systems on Door folding doors represent a combination of accuracy, minimalism, elegance and practicality. There are two possible closing systems: with an aluminium profile or without a profile.

The closing system with a profile, combined with a visible track, creates a frame guaranteeing aesthetic continuity.

The solution without a profile, integrated with the built-in track, is perfect for creating clean lines, the utmost expression of the minimalist aesthetic. In both systems, the door is closed by a magnet, which may be integrated into the profile or set into the wall.

Use of a special closing system with a latch or with a latch and lock using the European cylinder system (optional) makes for more solid closure.

Closing system with profile

Lateral closing



Central closing



Closing system without profile

Lateral closing



Central closing

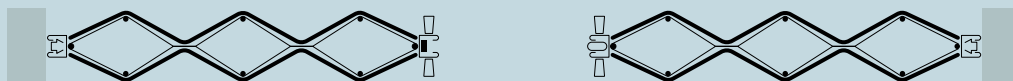

Handles

The Door handle is the result of in-depth ergonomics and aesthetic research, an elegant accessory underlining the folding door's practicality, especially when in motion.

CB#1

75 x 25 x 300mm



CB#2

29 x 18 x 216mm



CB#3

29 x 18 x 130mm

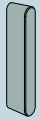

CB#4

Handle
29 x 18 x 130mm



Latch
29 x 18 x 43mm



CB#5

Latch
29 x 18 x 43mm



Cladding

The Door folding door is available with a vast range of cladding materials and becomes an element of great character that will stand out in the space where it is installed if clad with decorative fabrics.

If clad with matt fabrics or materials, similar to the surrounding walls, it blends into them and becomes a subtly elegant echo. The door may be clad in different materials on each side: so while one side may be in keeping with a modern, minimalist space, the other may have a completely different feel and look.

Right side



Left side



Product Features

The door stretches upwards and to the side, as shown below: its height is equal to the height of the space in which the door will be installed, reduced by 5 to 10mm to ensure proper opening and closing.

The maximum available height is 6000mm. As it is a modular door, widths may be found in the specifications table below, corresponding to the size equal to or immediately bigger than the opening.

The door weighs about 7,5kg per square metre, depending on the cladding material. Doors weighing over 60kg should be installed with the unlimited modular coupling system, distributing the weight of the door for easier installation and maintenance.

The thickness of the door varies from a minimum of about 100mm (with door fully extended) to a maximum of about 180mm (with door fully folded), depending on the thickness of the cladding.

Design note: it is in any case advisable to leave a space of about 220 mm to take into account the thickness of the door.

The folding door has an internal magnetic coupling system included for holding back the folded door, in order to reduce its bulk and increase the amount of space available in the doorway, with a maximum width of 1550 mm.

Specifications table (fixed product widths in mm)	0680	0825	0970	1115	1260	1405
	1550	1695	1840	1985	2130	2275
	2420	2565	2710	2855	3000	3145
	3290	3435	3580	3725	3870	4015
	4160	4305	4450	4595	4740	4885

Overall dimensions
of fully extended door

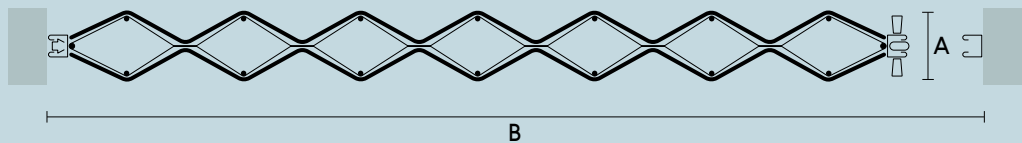

Overall dimensions
of folded door

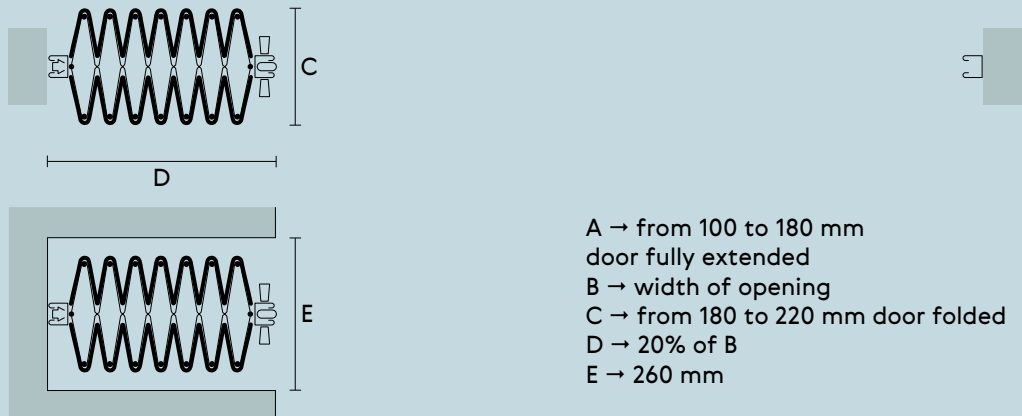

- A → from 100 to 180 mm
door fully extended
- B → width of opening
- C → from 180 to 220 mm door folded
- D → 20% of B
- E → 260 mm

Product Features

Internal magnetic block
(upon request)



Unlimited modular
coupling system



Colour variations tracks, profiles and handles

Satin oxidised
aluminium



Semigloss white
RAL 9010

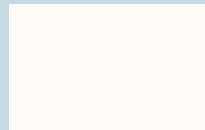

Matt black
RAL 9005



Note: RAL colours available on request

Colour variations seals

Cold Grey

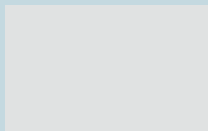

Matt white

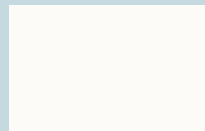

Matt black



Dooor
Via Ugo La Malfa,
27/D
61032 Fano — PU
Italy

info@dooor.it
dooor.it

dooor

