

Foreg 2000
Shelving System

asset
space becomes place

FOREG 2000

Systematic archiving



FOREG 2000 Mobile shelving

Modular construction for more space



The very varied demands placed upon a productive storage system can be met in full with the installation of a FOREG mobile shelving system. FOREG 2000 creates space and order.

FOREG is easy to operate

The operation of the mobile shelving is effortless and ensures rapid and problem-free access to the materials kept in archives and stores.

FOREG is flexible

Even at the planning stage, differing sizes and drive systems plus an extensive selection of interior fittings and many other features cater for widely varying materials and local conditions. The design of the system is such that all the components are fully interchangeable and extendable.

FOREG is at home everywhere

Regardless of whether it's for use in a small records office or an extensive archive, this system offers the optimum solution for every day usage. Planned and installed by specialists, the shelving systems can cope with the most extreme demands.



FOREG is reliable:

By using high quality materials and the most modern production technology, reliability and function of mobile shelving systems is ensured.





Saving space means saving costs

Making the very best use of the space available becomes possible with a mobile shelving system. In contrast to fixed shelving, only the access specifically required needs to be open. In this way almost double the normal storage space is made available.

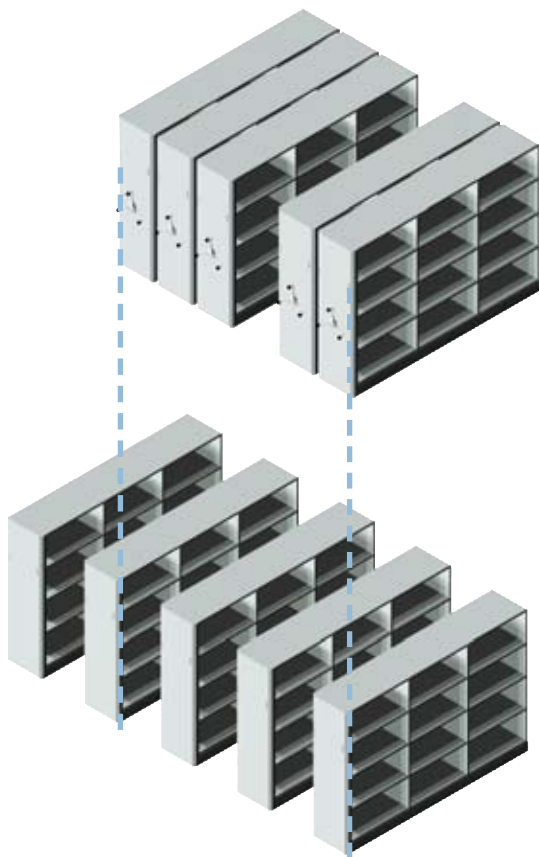

Heavy loads are easily moved

Rail and wheel - a perfect combination

A proven system of running and guide wheels, combined with matching rails, makes it possible to move heavy loads with minimum effort. The heavy duty rails, with an internally fitted guide system, can either be laid on the structural floor or, in the case of an existing floor area, fitted with a platform floor.



Drive methods



Push/pull drive

For maximum loads up to 2000 kg per mobile unit

Crank driven

For maximum loads up to 5000 kg per unit
Driven by 'floor chain' or friction drive

Electronic Drive

The electronic drive moves loads in excess of 5000 kg per mobile unit with ease

- Each mobile unit moves individually in a cascade motion
- The in-base motors connect to a fixed floor chain to provide positive drive
- Systems can be customised with the desired safety features from an available menu (i.e. motor current monitoring system: MCMS; photo cell aisle monitoring etc.)
- Numerous operational settings are available (i.e. night mode; fire park position; general locking; rights of access to individual units; spacing between adjacent units, etc.)
- Electronic mobile systems use state-of-the-art plug & play technology and can be easily expanded as you wish.



A suitable size for every requirement - so that there is room for everything

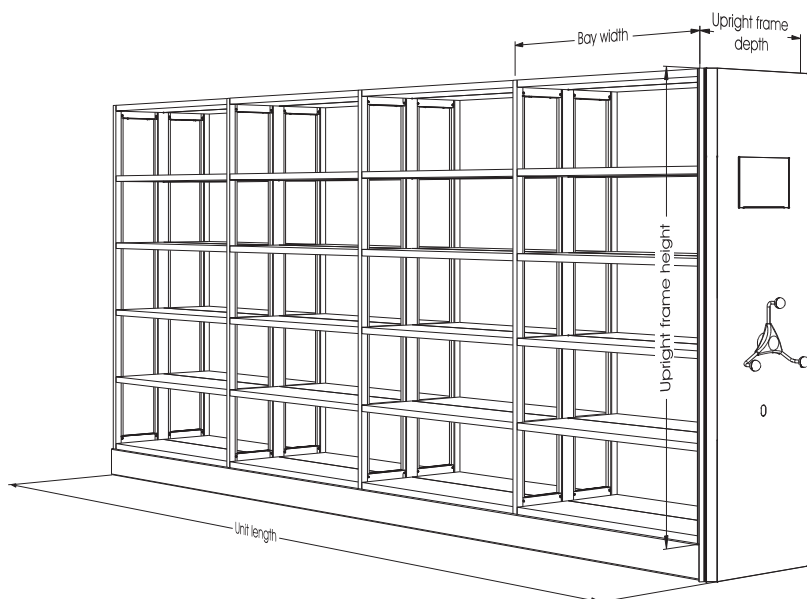

Maximum single loads/ load-bearing capacity (Standard system):

Shelf:

- Bay width 900 mm: max. 140 kg
- Bay width 1000 mm: max. 130 kg
- Bay width 1100 mm: max. 120 kg
- Bay width 1200 mm: max. 110 kg
- Suspension rod: 50 kg
- Suspension rod with reinforcement: 130 kg
- Pull-out filing frame: 60 kg
- Drawer: 60 kg

Surface area:

All parts are galvanised and/or powder coated (RAL 7035 light grey). Other colours within our current colour range are available for end panels.

Quality assurance:

Our production complies with requirements under:

- RAL quality mark
RAL-RG614/1
RAL-RG614/4
- GS mark (certified safety)
- Quality management system as per ISO 9001:2008
- Environmental management system as per ISO 14001:2009

Measurements

| Upright frame heights: | Upright frame depths: | Bay widths: |
|------------------------|-----------------------|-------------|
| 1632 mm | 250 mm | 900 mm |
| 1832 mm | 300 mm | 1000 mm |
| 1952 mm | 350 mm | 1100 mm |
| 2032 mm | 400 mm | 1200 mm |
| 2112 mm | 450 mm | |
| 2232 mm | 500 mm | |
| 2312 mm | 600 mm | |
| 2592 mm | 700 mm | |
| 2952 mm | 800 mm | |

Unit height:

Upright frame height + 162 mm (mobile base + distance from floor)

Unit depth:

Upright frame depth + 30 mm safety factor

Unit length:

x times bay width + 100 mm cladding to unit end or chain box



Versatile and extendable at

End panels and upright frames

The appearance of the shelving and its function, since perforated end panels and upright frames ensure better air flow, can be determined with a choice of panels.

Four different types of end panels are available. The card-holders assist in determining the content of the units.

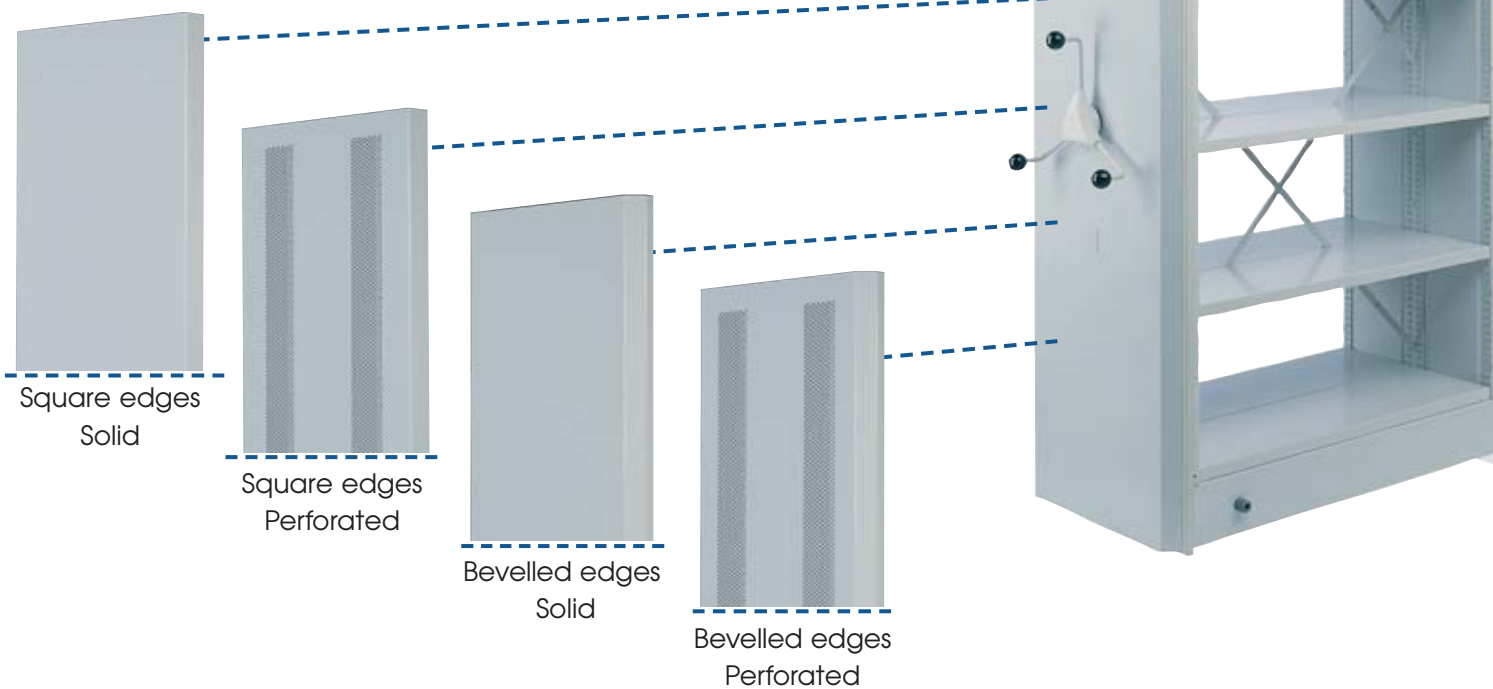

New design choices

This innovation puts colour into many a grey office environment. The digital printing process allows imprinting the shelf panels with a variety of designs. Whether lovely holiday snapshots, majestic architecture or fascinating works of art and regardless of the size of the print – there are virtually no bounds to your flights of imagination.



any time - the appearance of FOREG 2000

Claddings

Several options of infill panel types are available and these can be selected according to individual requirements.



Frames with laminated hardboard



Closed frames with perforated steel 6 mm Ø



Closed frames with solid steel



Open frames

Doors

Hinged or sliding doors make it possible to close off single or several shelving bays. In this way, valuable archive material can be protected from both dust and unauthorised access.



Sliding doors
made of sheet steel; lockable. Sliding doors run on rollers within a guide track.



Hinged doors
made of sheet steel; lockable.

Static shelving

Versatile solutions

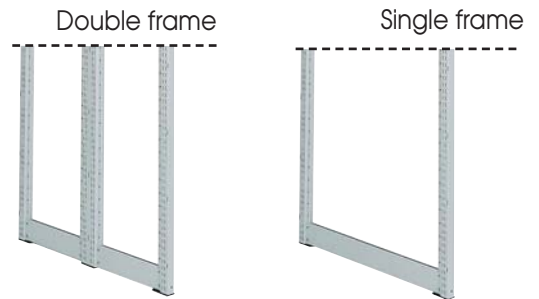
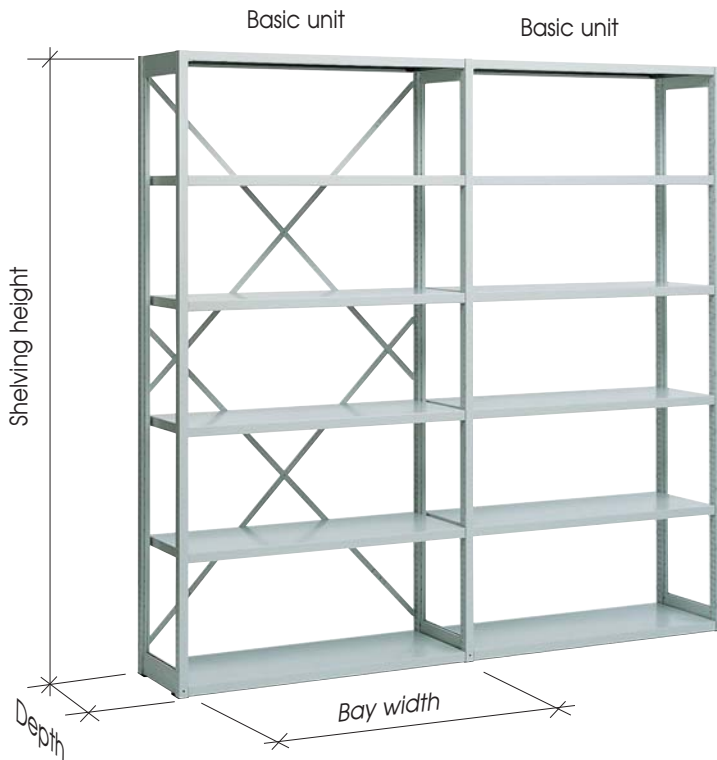

Steel plinth

Dimensions

Height: 1632, 1832, 1952, 2032, 2112, 2232, 2312, 2592 and 2952 mm
(plus 3 mm high plastic base plates)

Depth: 250, 300, 350, 400, 450, 500, 600, 700 and 800 mm

Bay width: 900, 1000, 1100 and 1200 mm

Slotted frame profile: Special steel profile

Shelf: 32 mm in height; triple-folded longitudinal edges;
height-adjustment: 20 mm increments

Capacity

Bay capacity: Depending on upright frame type max 2000 kg

Shelf capacity:
Bay width 900 mm: max. 140 kg
Bay width 1000 mm: max. 130 kg
Bay width 1100 mm: max. 120 kg
Bay width 1200 mm: max. 110 kg

The right accessories - flexibility extends the possibilities

The varying components of the wide-ranging accessory programme can be freely combined and incorporated or moved at any subsequent stage. Each of the fitments may, like the shelves, be adjusted at 20 mm increments.

The shelf

Accessories for all requirements

The range of accessories covers the multitude of requirements and needs of our customers. Well-designed and practical system components are clear indicators of the consideration given to perfecting the shelving system.



Pull-out shelf



Front stop



Back stop
different heights

Shelves for books and files

Secure storage for all archived materials

High-quality materials and superior workmanship guarantee a long and useful life. The intelligent design adapts optimally to its overall appearance, ambience and surrounding. The strong connection of shelf and vertical divider provides reliable stability in all situations.



Side stop, plastic



Side stop, steel



Suspended divider, rod type,
suspended divider, flat steel



Angled book-end,
on-shelf divider



Angled book-end, with stop

Labelling

Finding your way

An intelligent structure and clear labelling are the best guides through an archive. Labelling panels and strips are available in several designs, using paper inserts for easy identification. A4 and A5 sized cardholders can be positioned as portrait or landscape format.

System accessories

Prepared for all contingencies

We offer suspension rods suitable for systems made by a number of manufacturers, and drawers in a wide range of heights.



Dividers and rod dividers



Drawers

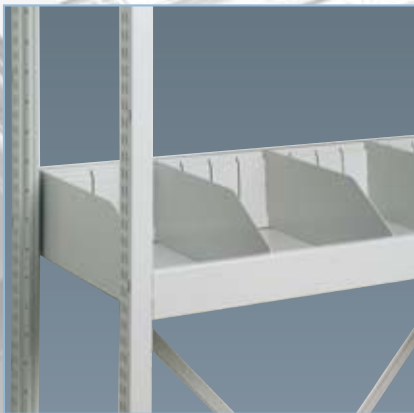

Box shelf



Pull out filing cradle



Suspension rod



Cardholder



Protruding cardholder



Labelling strip for shelves

Shelving system FOREG 2000

Overall

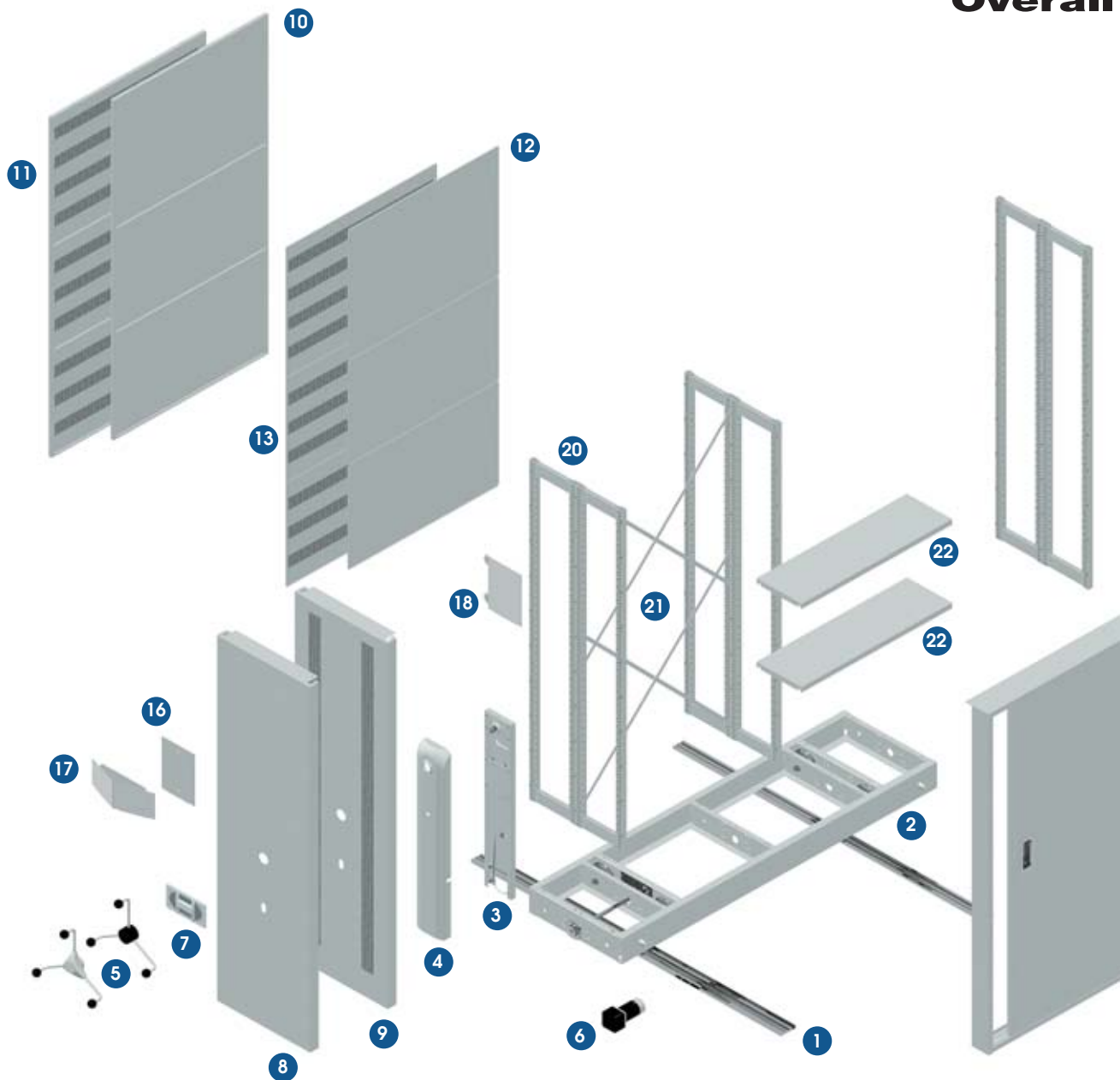

- | | | |
|-------------------|---------------------------------|----------------------------|
| 1 rails | 8 end panel, solid steel | 16 cardholder |
| 2 mobile base | 9 end panel, perforated steel | 17 protruding cardholder |
| 3 chain box | 10 rear panel, solid steel | 18 cardholder |
| 4 chain box cover | 11 rear panel, perforated steel | 19 shelf labelling |
| 5 handcrank | 12 back panel, solid steel | 20 frame |
| 6 electric drive | 13 back panel, perforated steel | 21 diagonal braces |
| 7 control panel | 14 sliding doors | 22 shelf, solid steel |
| | 15 hinged doors | 23 shelf, perforated steel |

view components

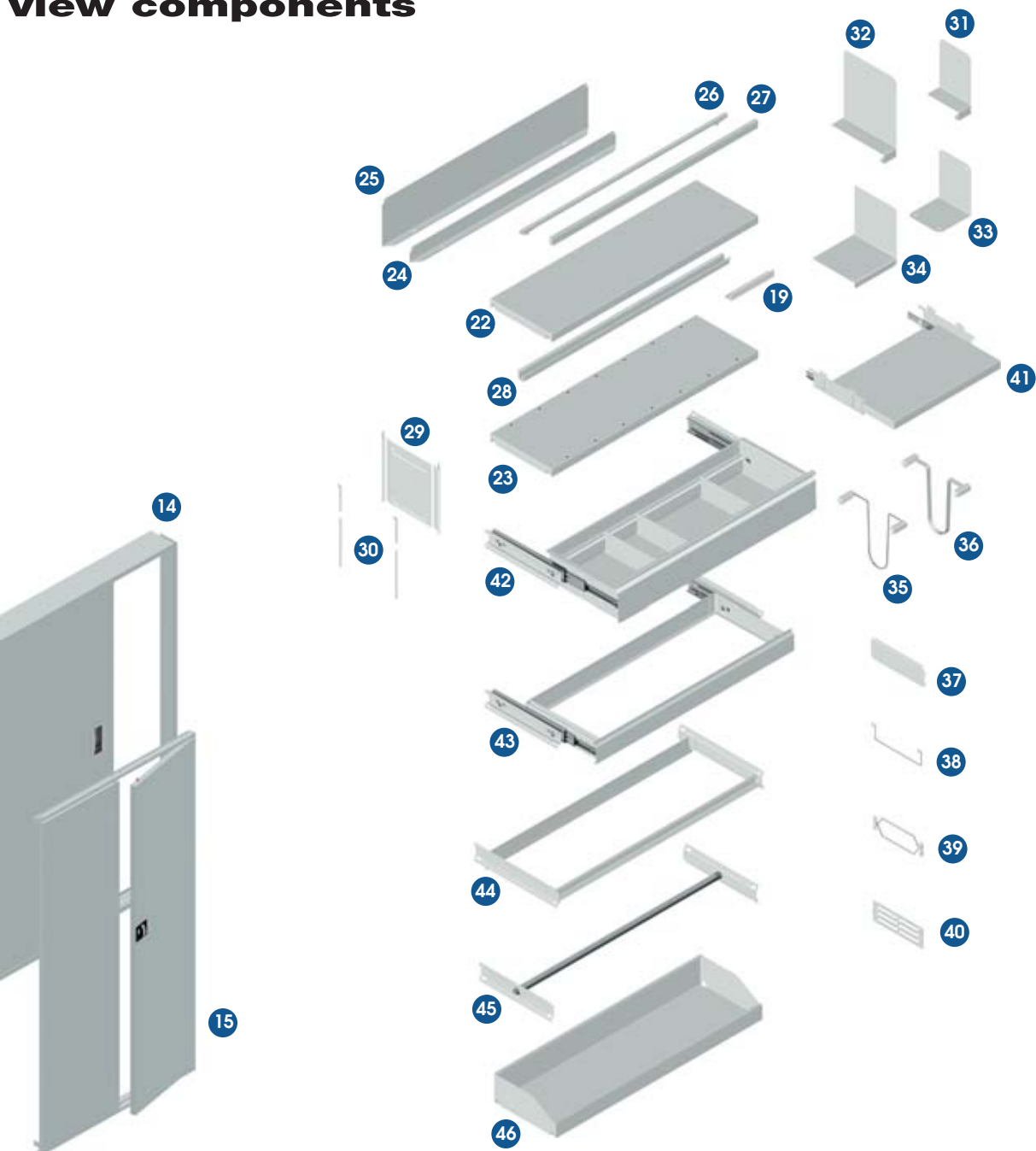

24 back stop, low

25 back stop, high

26 centre stop

27 front stop

28 shelf reinforcement

29 shelf divider, steel/hardboard

30 rod dividers

31 on-shelf divider, small

32 on-shelf divider, large

33 angled book-end

34 angled book-end, with stop

35 suspended divider, rod type

36 suspended divider, flat steel

37 side stop, solid steel

38 side stop, rod type

39 side stop, rod type

40 side stop, plastic

41 pull-out shelf

42 drawer

43 pull out filing cradle

44 fixed filing frame

45 suspension rod

46 box shelf

Solutions based on project re

Variety in

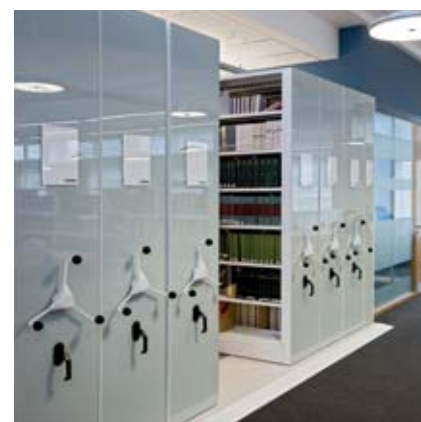

A shelving system, when planned and designed with optimal effect, will guarantee an efficient work flow and a supportive ambience for the daily work routine. Drawing on a well-considered and highly variable standard programme, project-specific solutions are developed through the direct interaction between our experienced in-house specialists and our clients. Individual applications emphasise architectural accents. The flexibility of our manufacturing operations allows us to accommodate most of the technical and design wishes. We measure our progress by our clients' requirements which are always reflected in new developments of our standard programme.

quirements

technique and design – simply the perfect solution



Optimal solutions for customers:



Library shelving systems stationary and mobile

FOREG library systems are functional,
user-friendly and timelessly elegant design.
Static and mobile versions are available.



FOREG 2000-L

... for flexible office applications.



FOREG 3000 Picture storage

extendible for the storage of paintings
in archives and museums.



